



WRIGHT COUNTY DEPARTMENT OF HIGHWAYS

*Wright County Public Works Building
3600 Braddock Avenue NE
Buffalo, MN 55313*

*One-Half Mile North of C.R. 138
Telephone: (763) 682-7383
FAX: (763) 682-7313*

VIRGIL G. HAWKINS, P.E.
Highway Engineer
(763) 682-7388

CHAD D. HAUSMANN, P.E.
Assistant Highway Engineer
(763) 682-7387

STEVE P. MEYER
Highway Maintenance
Superintendent
(763) 682-7374

JEREMY S. CARLSON
Right-of-Way Agent
(763) 682-7386

WRIGHT COUNTY HIGHWAY AGGREGATE CRUSHING

NOTICE OF CALL FOR QUOTES - Sealed proposals will be received by the Highway Department of Wright County, Minnesota, until 9:00 a.m. on Friday, February 17, 2017, at the Public Works Building located at 3600 Braddock Avenue NE, Buffalo, Minnesota, 55313, for the Annual Aggregate Production and Stockpiling project.

Quotes shall be submitted on proposal forms which may be obtained at the Office of the Wright County Highway Engineer, Public Works Building, 3600 Braddock Avenue NE, Buffalo, Minnesota, 55313, located on Braddock Avenue, just one-half mile north of the intersection of TH 25/CR 138, or by calling 763-682-7383. Quote envelope should be labeled in lower left corner of envelope as to contents.

The Aggregate Production and Stockpiling project shall be completed on or before July 1, 2017.

Virgil Hawkins
Highway Engineer
Wright County, Minnesota

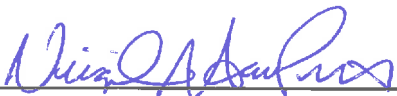

Signature

REQUEST FOR QUOTATION

STATE OF MINNESOTA
COUNTY OF WRIGHT

PROPOSAL FOR Aggregate Production and Stockpiling

Proposal of _____
(Name)

(Address)

To furnish and deliver all materials and to do and perform all work, in accordance with the Contract and the approved MINNESOTA DEPARTMENT OF TRANSPORTATION STANDARD SPECIFICATIONS for Highway Construction, 2016 EDITION, on file in the office of the County Engineer, shall govern, except as modified or altered in the "Special Provisions" contained herein.

Quotations will be received until 9:00 a.m. on the 17th of February, 2017. The point of delivery shall be at the Wright County Highway Department, 3600 Braddock Avenue NE, Buffalo, MN 55313.

SPECIAL PROVISIONS

(See attached)

To the Highway Department of Wright County, Minnesota:
Sirs:

In accordance with the advertisement of the County Coordinator, inviting proposals for the furnishing of **Aggregate Production and Stockpiling**, and in conformity with the Specifications and Special Provisions pertaining thereto, on file in the office of the County Engineer:

(I) (We) hereby certify that (I) (We) (am) (are) the only person(s) interested in this proposal as principal(s); that this proposal is made and submitted without fraud or collusion with any other person, firm or corporation whatsoever; that an examination has been made of the Contract Form, together with the Specifications and Special Provisions pertaining thereto.

(I) (We) understand that the quantities of work materials or equipment shown herein are approximate only and are subject to increase or decrease; that all quantities of work, whether increased or decreased within the limits specified in section 1903 of the Mn/DOT Specifications, are to be furnished at the unit prices shown on the attached schedule; and that, at the time of opening bids, totals only will be read, but that comparison of bids will be based on the correct summation of item totals obtained from the unit prices bid, as provided in section 1301 of the Mn/DOT Specifications.

(I) (We) propose to furnish all materials specified, in the manner and at the time prescribed, all in accordance with the terms of the Contract, Specifications, and Special Provisions forming a part thereof.

(I) (We) further propose to execute the form of Contract and to furnish a Contract Bond in the amount of the Contract, within ten (10) working days of the acceptance of this proposal, as security for the delivery of the materials or equipment in accordance with the terms of the Contract, Specifications and Special Provisions, as provided in section 1305 and 1306 of the Mn/DOT Specifications.

(I) (We) further propose to guarantee all materials or equipment delivered under this Contract to be in accordance with the Specifications, and Special Provisions; and to replace any materials or equipment which may be rejected due to defective materials or workmanship, prior to final acceptance by the County Engineer.

(I) (We) agree to all the provisions of Minnesota Statutes 1976, Section 181.59.

(I) (We) further propose to furnish the materials specified here as stated in the Special Provisions.

SPECIAL PROVISIONS FOR AGGREGATE PRODUCTION
AND
STOCKPILING

INDEX TO SPECIAL PROVISIONS

| <u>Section</u> | | <u>Page</u> |
|----------------|---|-------------|
| S-1 | Project Description | 1 |
| S-2 | Governing Specifications | 1 |
| S-3 | Scope of Work | 1 |
| S-4 | Aggregate Production | 1 |
| S-5 | Determination of Quantities | 1 |
| S-6 | Increased or Decreased Quantities | 2 |
| S-7 | (1807) Failure to Complete the Work on Time | 2 |
| S-8 | (1302) Award of Contract | 2 |
| S-9 | Time Schedule | 2 |
| S-10 | Sales Tax | 2 |
| S-11 | Worker's Compensation | 2 |
| S-12 | Final Payment | 2 |
| | Pit Location Map | 3 |
| | Pit Diagram | 4 |
| | Quotation Sheet | 5 |

I hereby certify that the special provisions contained in this proposal were prepared by me or under my direct supervision and that I am a duly Licensed Professional Engineer under the laws of the State of Minnesota.

Date 2/2/2017



Virgil G. Hawkins, Wright County Engineer
Lic. No. 19941

SPECIAL PROVISIONS

S-1 PROJECT DESCRIPTION

The work to be done under this contract shall consist of producing and stockpiling approximately 26,000 cubic yards of crushed aggregate for shoulder surfacing in the County-owned pit at the Highway Department Building site located 3600 Braddock Avenue NE, just one-half mile north of the intersection of TH 25/CR 138. (See Pit Location Map.)

S-2 GOVERNING SPECIFICATIONS

The 2014 Edition of the Minnesota Department of Transportation "Standard Specifications for Construction" shall apply on this contract, except as modified or altered in Special Provisions.

S-3 SCOPE OF WORK/MATERIALS

The price quoted for crushed aggregate shall include all equipment and all labor to produce and stockpile these materials as directed by the Engineer. The Contractor will be blending approximately 1,000 cubic yards of bituminous chunks (located in the pit). Bituminous Chunks for Class 7: Bituminous chunks will be crushed and stacked in a separate pile. Bituminous chunks will be blended with pit run supplied from another pit. (See enclosed pit diagram.)

Gravel material for the contract and clay material as needed to meet gradation at the Buffalo site will be furnished by the County at no cost to the Contractor.

Pit leveling operations before and after stockpiling shall meet the Engineer's approval before start of work.

The County Engineer or his representative will be available to view the pit location to clarify stockpile location or excavation area as an aid in determining a quote. Questions can be directed to Mr. Steve Meyer, Highway Maintenance Superintendent at 763-682-7374.

Quoted price shall include all work associated with production of the 26,000 CY of material, of which the actual amount of production could be slightly less or slightly more.

S-4 AGGREGATE PRODUCTION

Aggregate shall be produced in accordance with the provisions of 3138, except as modified below:

Aggregate material shall conform to the gradation requirements of 3138 Class 5 (Modified) material.

Gradations for Class 5
(Modified) are as follows:

Gradations for Class 7
(Modified) are as follows:

| <u>Sieve Size</u> | <u>Total Percent Passing</u> | <u>Sieve Size</u> | <u>Total Percent Passing</u> |
|-------------------|------------------------------|-------------------|------------------------------|
| 1" | 100 | 1" | 100 |
| 3/4" | 90-100 | 3/4" | 90-100 |
| 3/8" | 50- 90 | 3/8" | 50- 90 |
| #4 | 35- 80 | #4 | 35- 80 |
| #10 | 20- 65 | #10 | 20- 65 |
| #40 | 10- 35 | #40 | 10- 35 |
| #200 | 8- 12 | #200 | 8- 12 |

S-5 DETERMINATION OF QUANTITIES

Quantities will be determined by cross-section measure of aggregate stockpiles upon completion. Any materials hauled out of stockpile before completion of stockpiling will be paid for by vehicular measure (loose volume) and will be added to quantities determined by final cross-section measure. Compaction factors of 10 percent for stacking conveyors and 15 percent for dozer, loader, or truck stockpiling will be applied to final cross-section measure.

S-6 INCREASED OR DECREASED QUANTITIES
The provisions of 1903 shall not apply on this Contract.

The County reserves the right to increase the final quantity amount if it is in the County's best interest and materials are available to do so, at no change in unit price.

S-7 (1807) FAILURE TO COMPLETE THE WORK ON TIME
The liquidated damages for failure to complete the work on time shall be in accordance with the provisions of 1807.

S-8 (1302) AWARD OF CONTRACT
The provisions of 1302 are hereby supplemented by the following:

Wright County reserves the right to award the contract based on the lowest quote received in the best interest of the County and to waive any informalities and irregularities in the quotes.

S-9 TIME SCHEDULE
All work shall be completed on or before July 1, 2017.

S-10 SALES TAX
Wright County has exempt status as of 1/1/2014, as per Minnesota Statute 297A.70, Subdivision 2.

S-11 WORKER'S COMPENSATION
Prior to commencement of Contract term, the successful Contractor shall submit appropriate documentation evidencing compliance with the Worker's Compensation insurance coverage requirement of M.S. 176.182 set forth in pertinent part herein:

M.S. 176.182 BUSINESS LICENSES OR PERMITS: COVERAGE REQUIRED.

...Neither the state nor any governmental subdivision of the state shall enter into any contract for the doing of any public work before receiving from all other contracting parties acceptable evidence of compliance with the workers' compensation insurance coverage requirement of Section 176.181, Subdivision 2.

In any case where subcontracting is approved, the Contractor shall require the subcontractor to provide worker's compensation insurance, all in accordance with statutory requirements. Evidence of subcontractor's insurance shall be filed with the County.

S-12 FINAL PAYMENT
The County hereby agrees to pay the successful Contractor when the terms and conditions of the contract and specifications have been fully completed and fulfilled on the part of the Contractor to the satisfaction of the County, the sum of the bid price.

Before final payment is made, the Contractor shall also make a satisfactory showing that he has complied with the provisions of Minnesota Statutes 290.92 requiring the withholding of State income tax from wages paid to the Contractor's employees for work performed under the contract. Receipt by the Highway Engineer of a Certificate of Compliance from the Department of Revenue (Form IC-134) will satisfy this requirement. The Contractor is advised that, before the certificate can be issued, he must first place on file with the Commissioner of Revenue, an affidavit stating that he has complied with the provisions of M.S. 290.92. The required affidavit form will be supplied by the Commissioner of Revenue, Centennial Office Building, St. Paul, MN 55145, upon request.

Payment under the contract will be made in the manner provided by law for payment of claims against the County.

Wright County

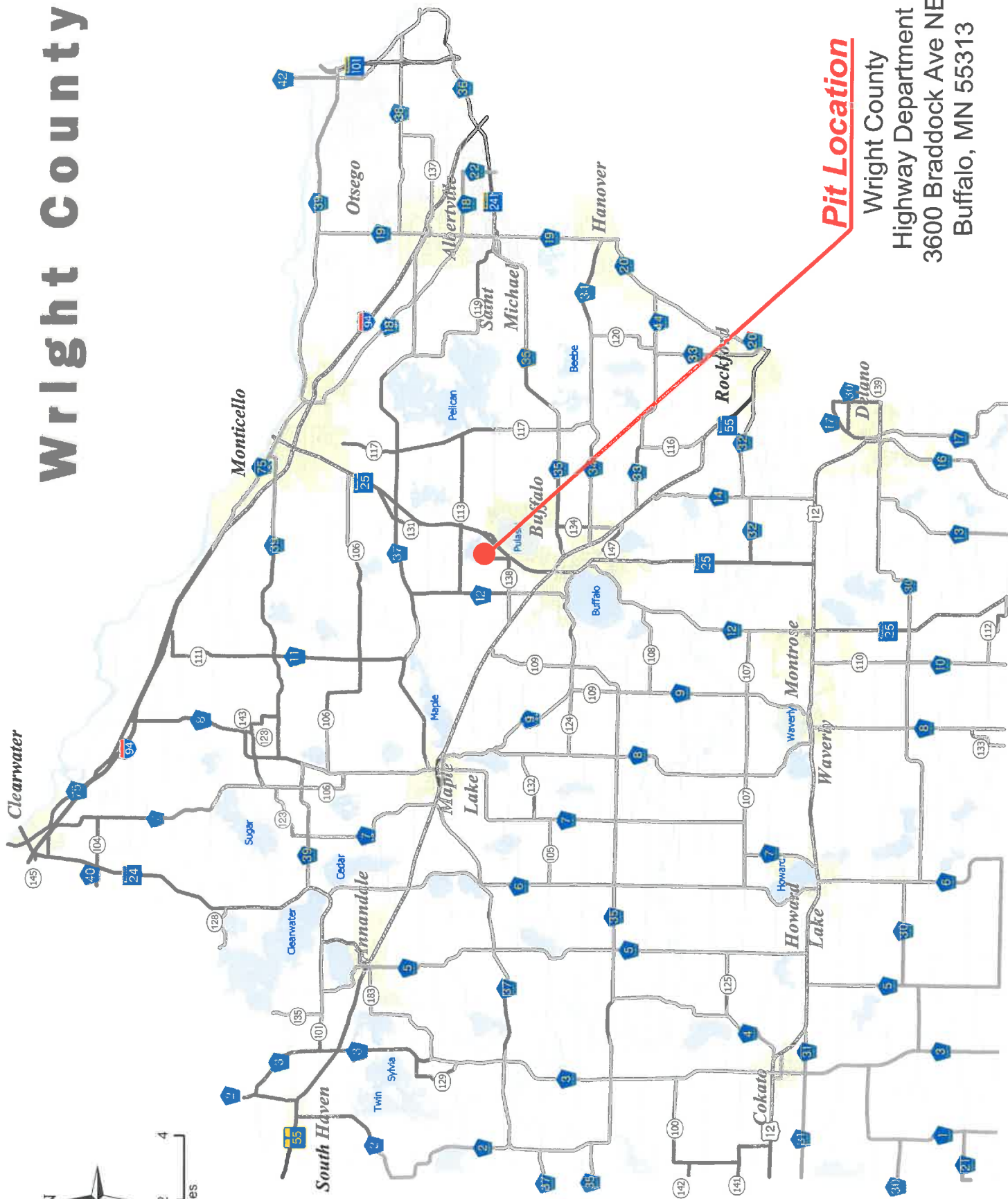

Pit Location

Wright County
Highway Department
3600 Braddock Ave NE
Buffalo, MN 55313

WRIGHT COUNTY 2016 AGGREGATE
CRUSHING & STOCKPILING

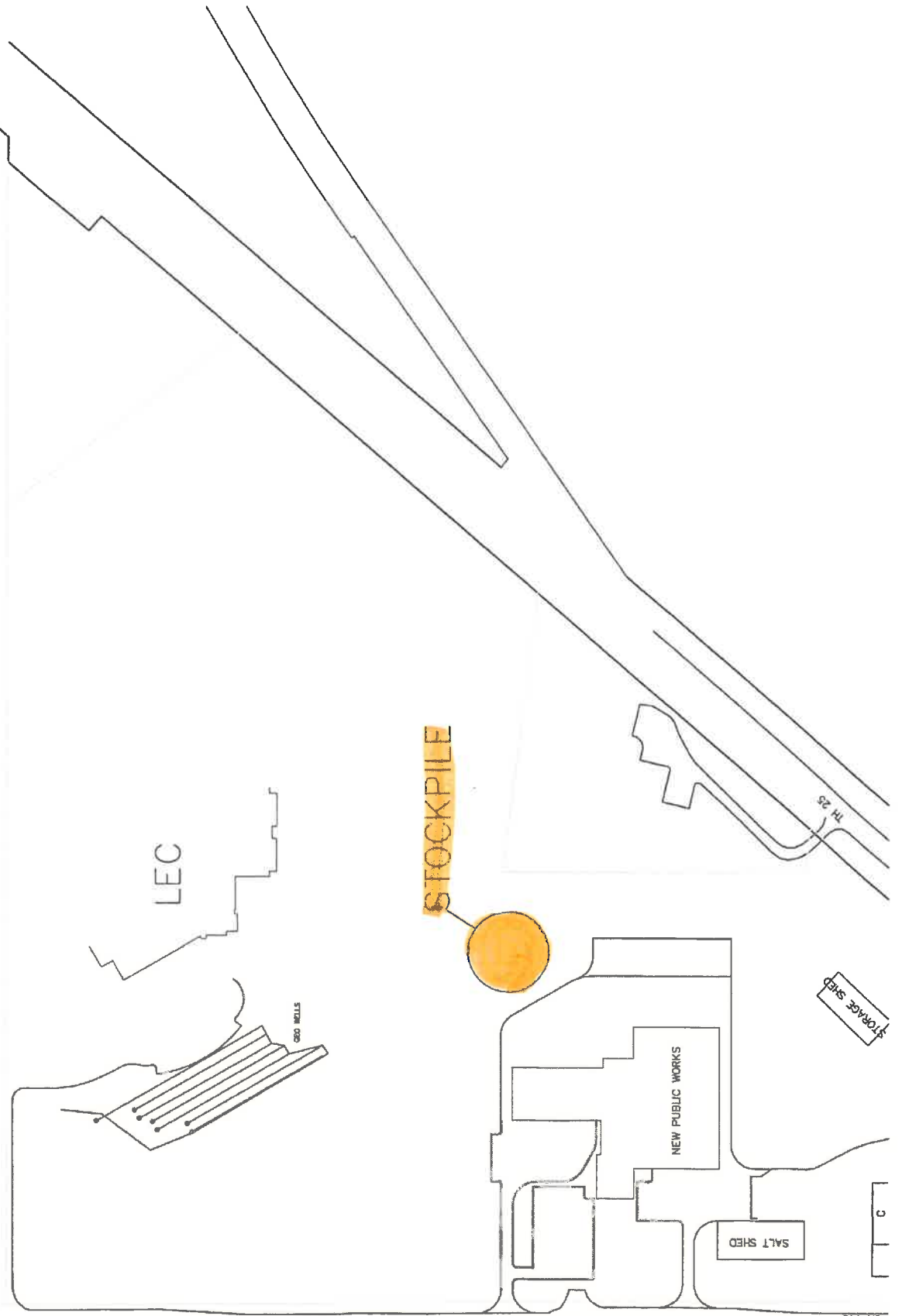

CR 148

**QUOTATION SHEET
for
STOCKPILING
WRIGHT COUNTY HIGHWAY DEPARTMENT**

| SCHEDULE OF PRICES | | | | | | | | |
|------------------------------------|--------------------------------------|--|---------|--------------------|------------|--|--------|--|
| AGGREGATE CRUSHING AND STOCKPILING | | | | | | | | |
| Spec. or Item No. | Item Description and Unit of Measure | | | Approx. Quantities | Unit Price | | Amount | |
| | | | | | Dollars | | | |
| 2211.506 | Stockpile Aggregate Class 5 Special | | Cu. Yd. | 25,000 | | | | |
| | Stockpile Aggregate Class 7 Special | | Cu. Yd. | 1,000 | | | | |

Date

Signature of Contractor

Title

Firm Name

Address

Telephone